

CITY OF LAKE CITY  
MISSAUKEE COUNTY, MICHIGAN

Resolution Number 2022-08

A RESOLUTION OF INTENT TO AUTHORIZE THE MAYOR AUTHORITY TO  
NEGOTIATE FOR THE LOTS 6-7-8-9-10 AND 11 OF BLOCK 4 OF THE  
ORIGINAL PLAT OF LAKE CITY.

THIS RESOLUTION TO BE EFFECTIVE IMMEDIATELY FOLLOWING  
ADOPTION.

Recorded in the minutes of a Regular Meeting of the City Council, City of Lake City,  
Missaukee County, Michigan held in the Lake City Municipal Building on the 14<sup>th</sup> day  
of March 2022 at 7:30 PM.

Present A. BARTOLOMEU, T. BARTZ,  
K. OSTRANDER, R. PICKFORD

Absent C. ELMQUIST & E. SELMER

The following motion and resolution were offered by Lake City Council  
Member PICKFORD, and supported by Lake City  
Council Member OSTRANDER.

**WHEREAS**, The City of Lake City has authorized, MAYOR ARDIS AUTHORITY TO  
NEGOTIATE THE PURCHASE PRICE OF THE LOTS CURRENTLY OWNED BY  
SUSAN OUWINGA; and,

**WHEREAS**, THE CITY COUNCIL OF LAKE CITY SHALL HAVE THE  
AUTHORITY TO PURCHASE THE AFOREMENTIONED PROPERTY  
FOLLOWING A MAJORITY VOTE OF THE FULL COUNCIL; and

**WHEREAS**, the granted authority shall become effective immediately after the adoption  
by the City Council of Lake City, and

**WHEREAS**, all requirements for the adoption of said resolution having been fully  
complied with;

**NOW THEREFORE, BE IT RESOLVED** by the Lake City Council, at a Regular  
Meeting of the City Council, held in the Lake City Municipal Building on the 14<sup>th</sup> day of  
March, 2022 at 7:00 PM Mayor Ardis be granted the aforementioned authority.

Clerk Judy Houle Date March 14, 2022



Wayward Geographics, LLC  
7880 Majestic Ave.  
Cadillac, MI 49601  
Phone: 231-368-9717  
Email: maps@waywardgeographics.com  
Web: www.waywardgeographics.com

# Lake City Parcel Maps

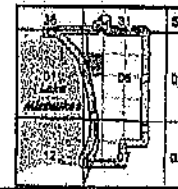

SW 1/4 of NW 1/4  
Section 6  
T22N, R7W

Aerial Photo Date: 2005  
Published: March 2009

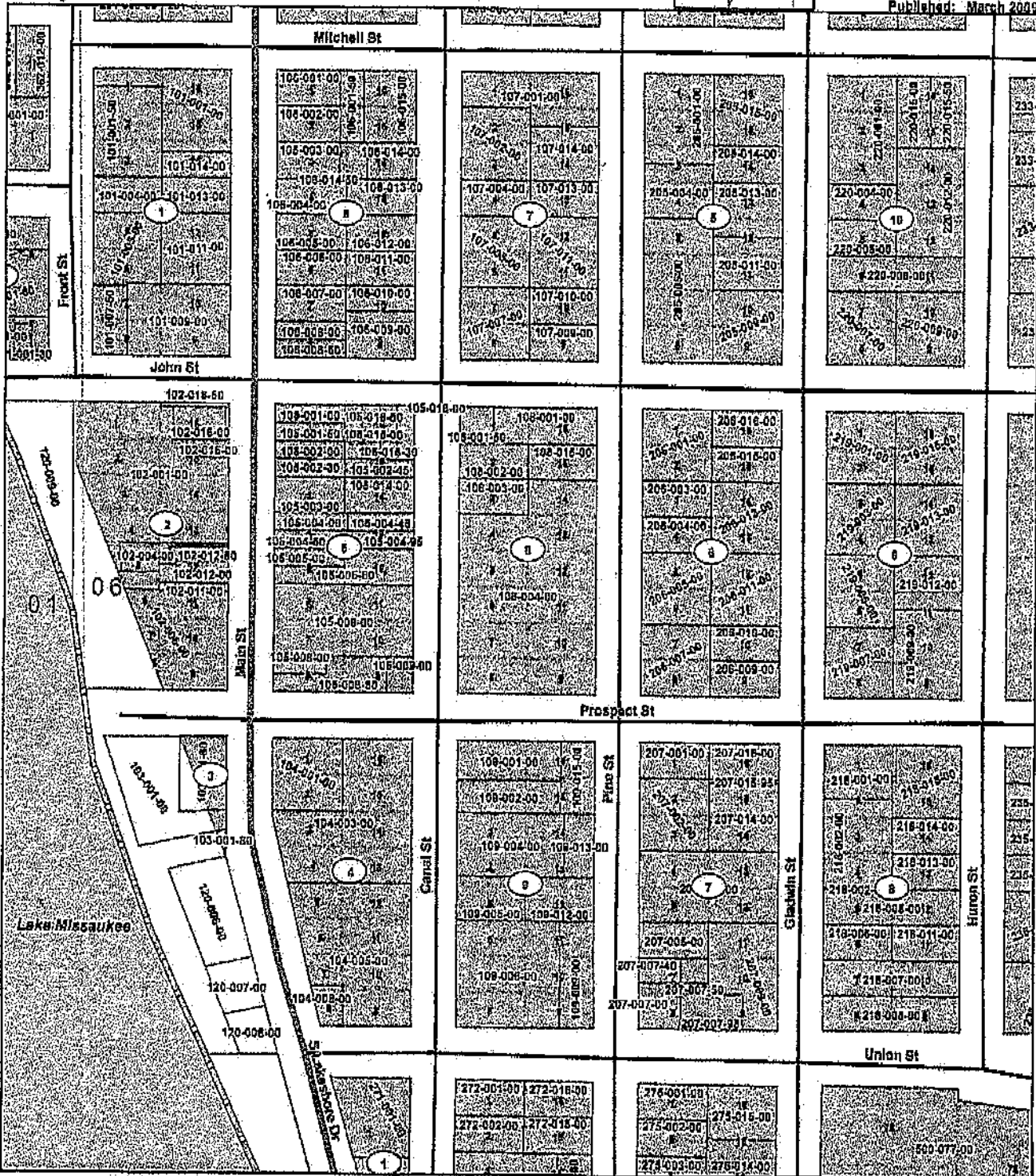

NOTE: All provided GIS data is to be considered a generalized representation which is subject to revisions. The feature boundaries are not to be used to establish legal boundaries. For specific information, contact the appropriate county department or agency. This information is provided as a visual representation only and is not intended to be used as a legal or official representation of legal boundaries.

