

APPENDIX C: FIGURES

(A) *Building height.* See definition in § 152.006.

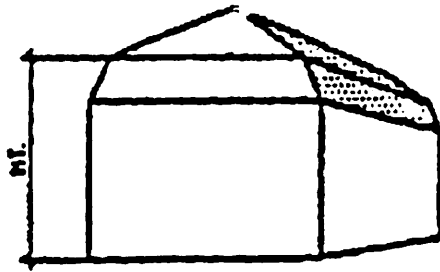

MANSARD ROOF

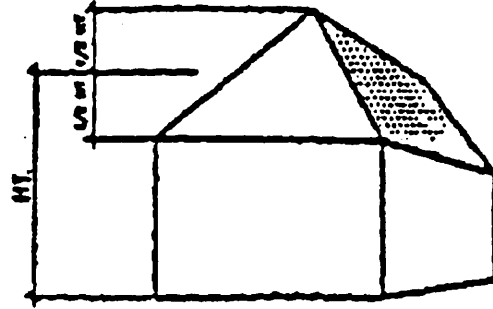

HIP ROOF

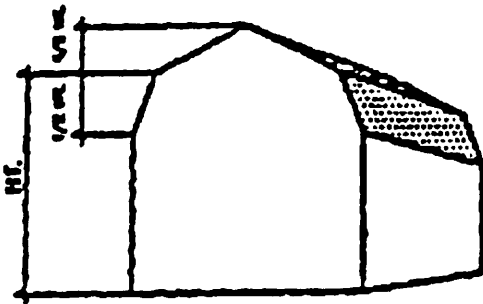

GAMBREL ROOF

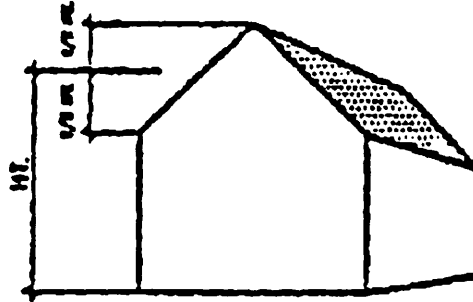

GABLE ROOF

NOTE: HT. = HEIGHT OF BUILDING

BUILDING HEIGHT

(Ord. A-38, § 2.10, passed 10-18-1988)

(B) *Building setback*. See definition in § 152.006.

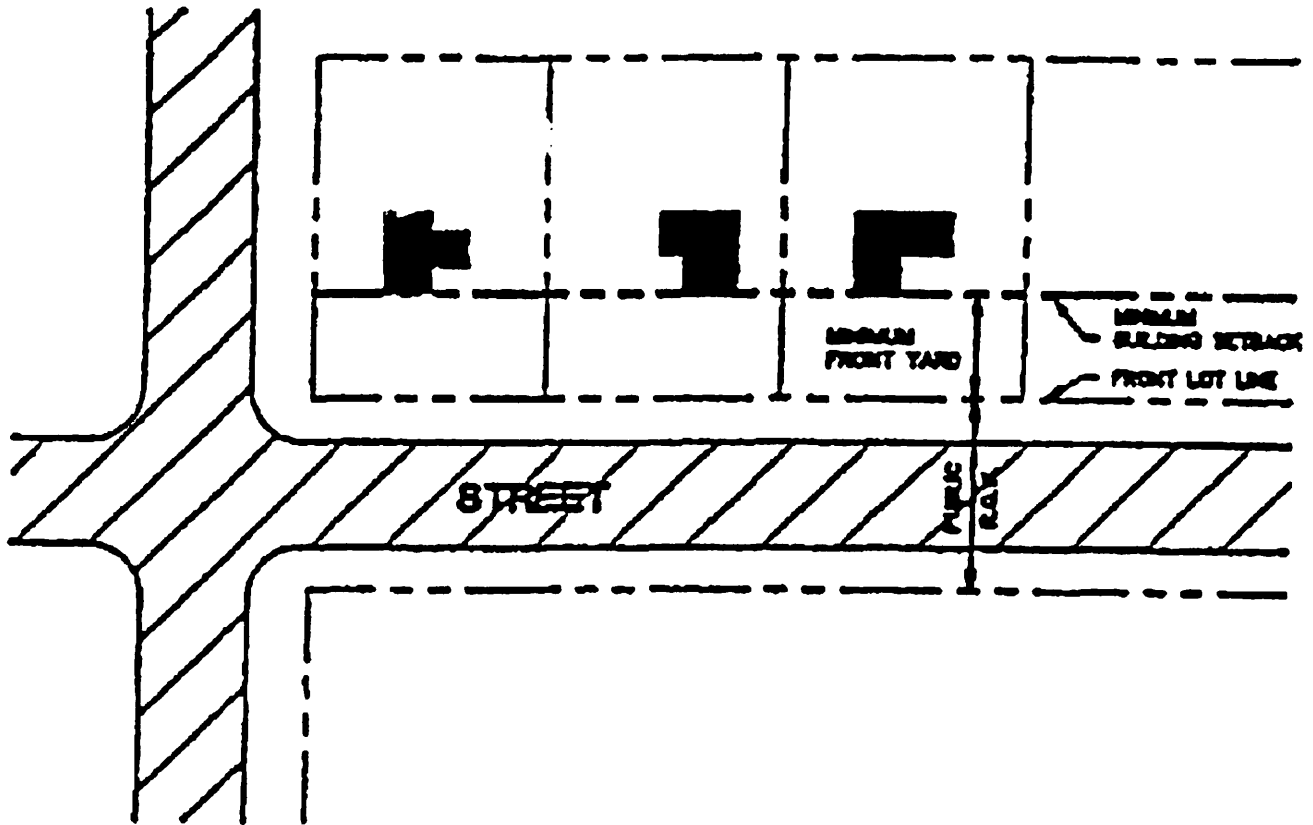

BUILDING SETBACK

(Ord. A-38, § 2.11, passed 10-18-1988)

(C) *Corner, interior and through lots.* See definitions in § 152.006.

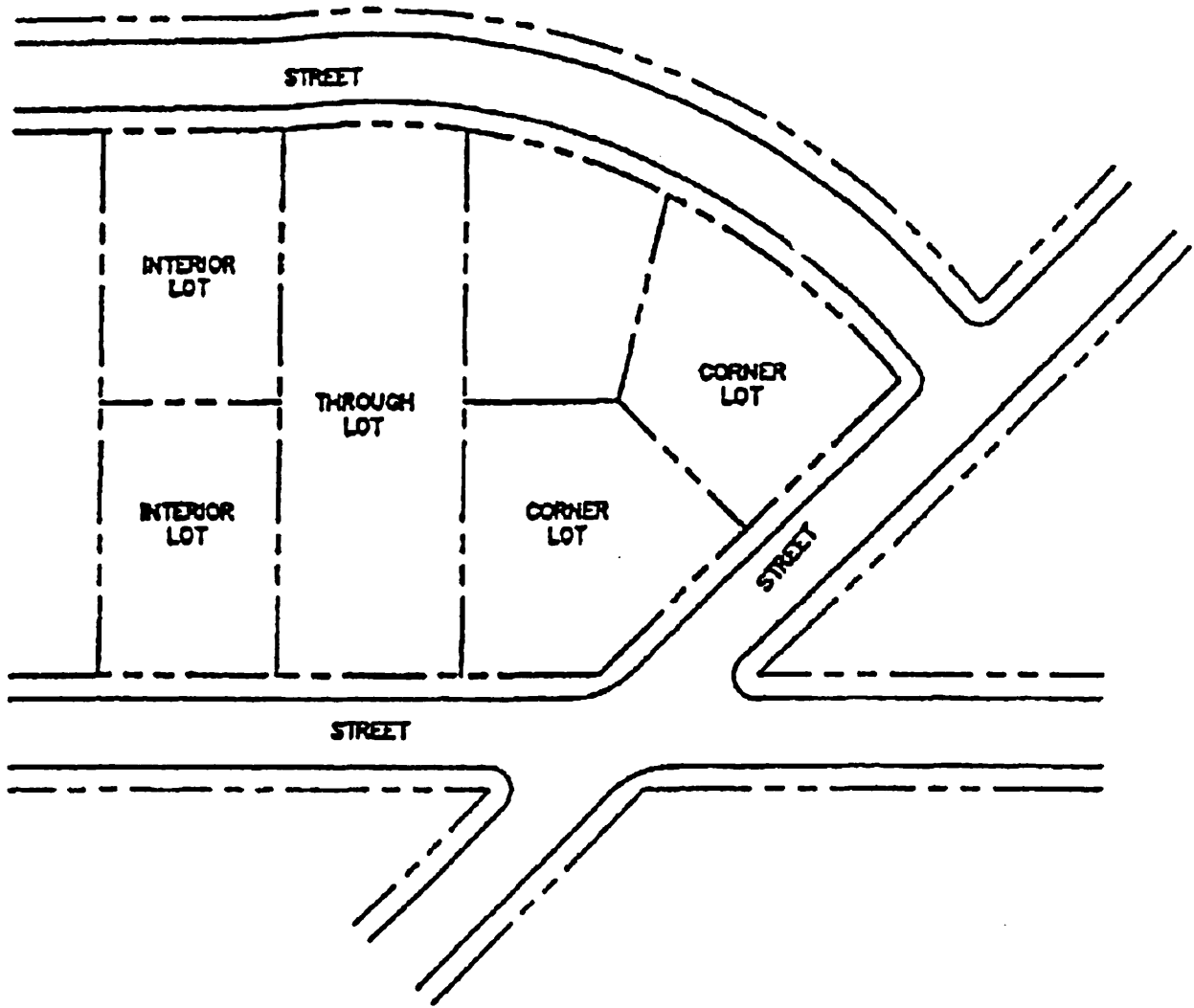

CORNER, INTERIOR & THROUGH LOTS

(Ord. A-38, § 2.24, passed 10-18-1988)

(D) Lot lines. See definitions in § 152.006.

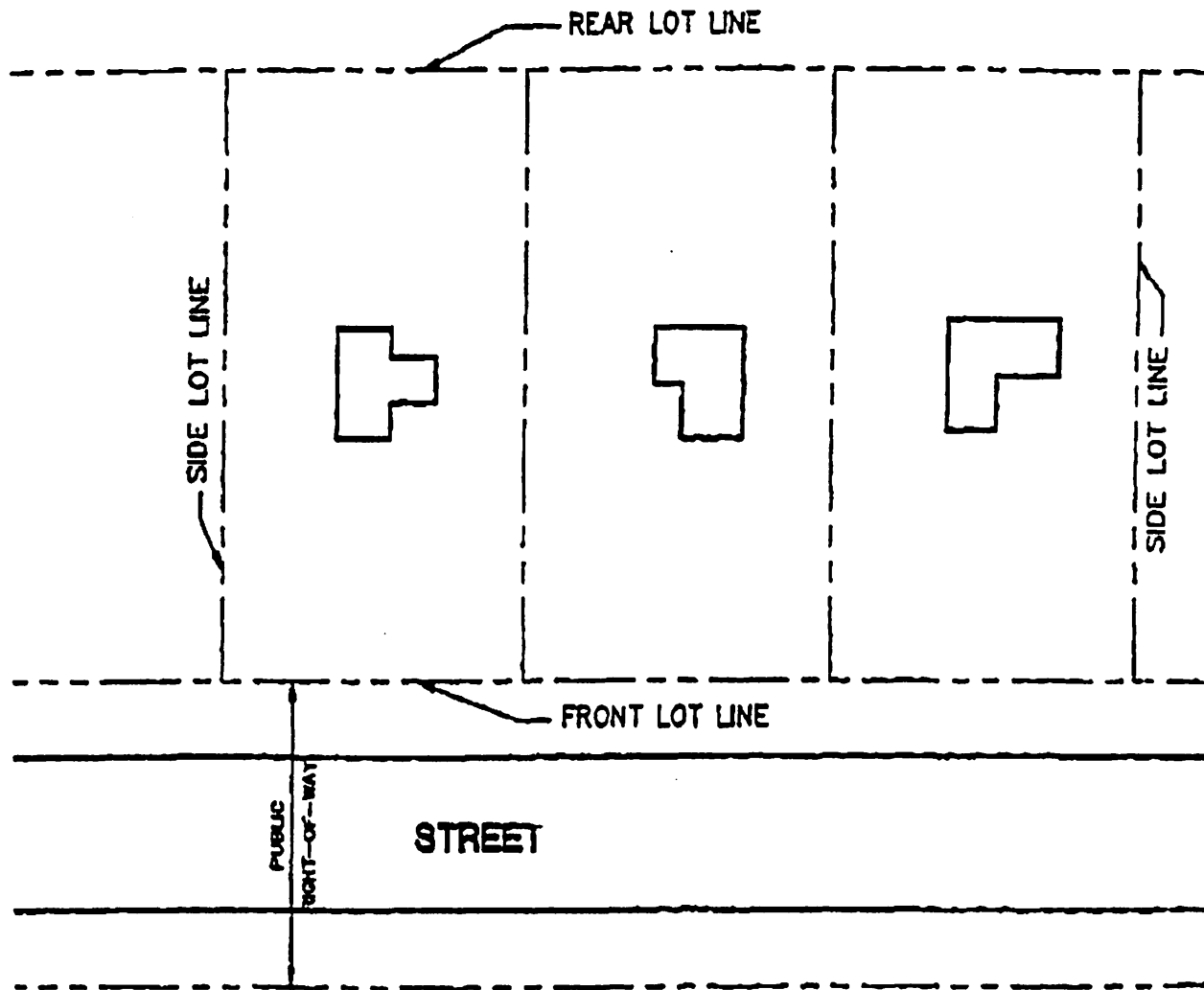

LOT LINES

(Ord. A-38, § 2.25, passed 10-18-1988)

(E) *Yards.* See definitions in § 152.006.

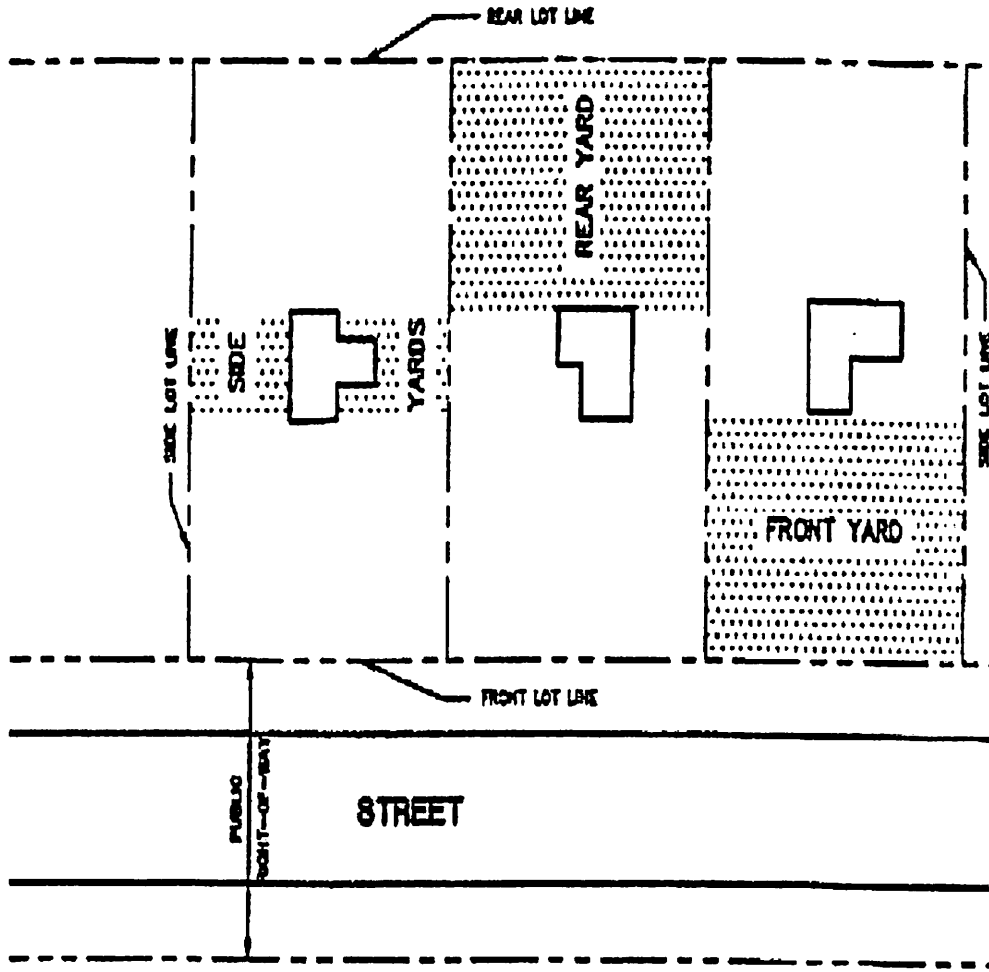

YARDS

(Ord. A-38, §§ 2.44-2.47, passed 10-18-1988)

(F) *Corner clearance.* See corner lot regulations in § 152.058.

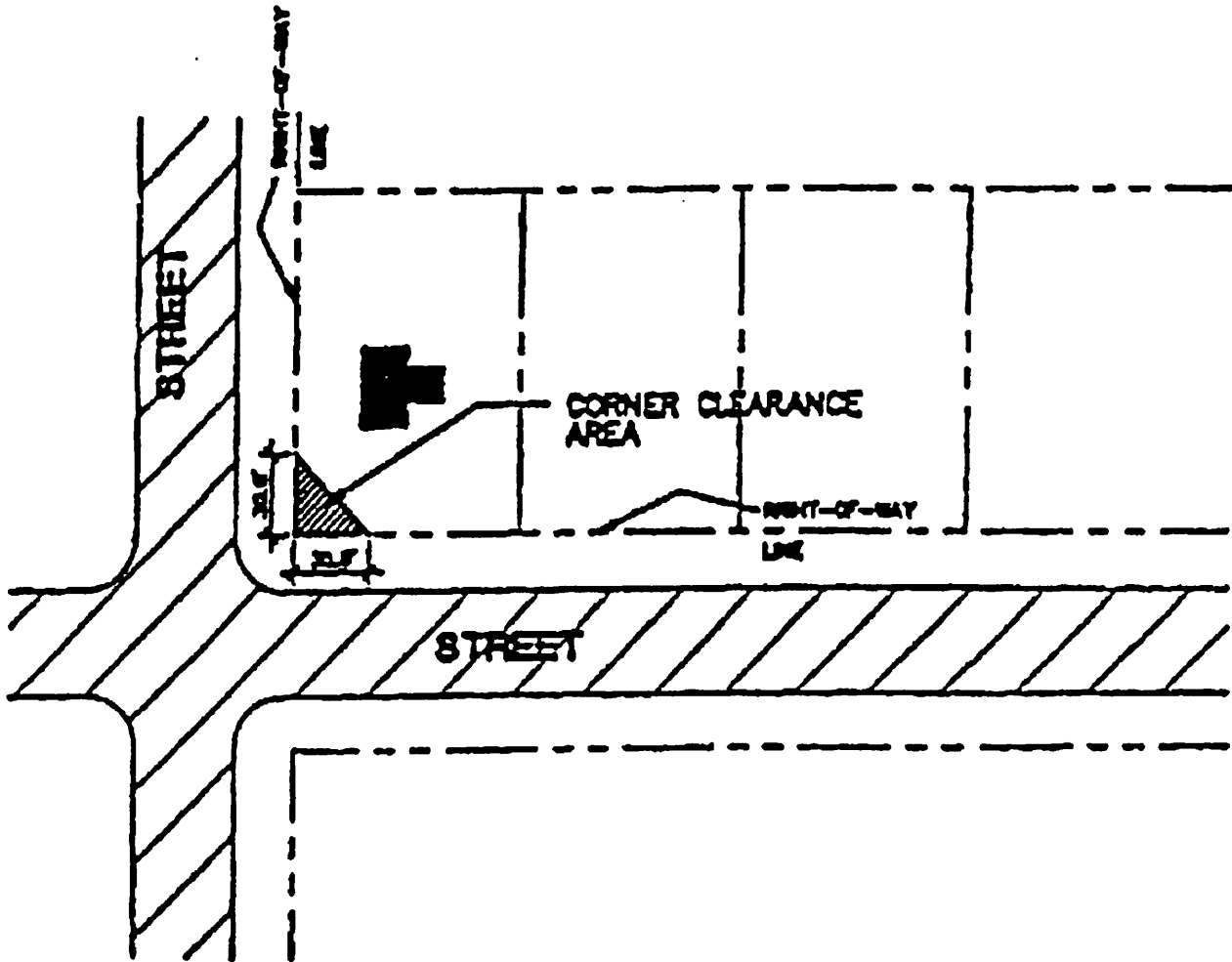

CORNER CLEARANCE

(Ord. A-38, § 3.04, passed 10-18-1988)

(G) *Non-conforming uses, structures and lots.* See regulations in §§ 152.135 et seq.

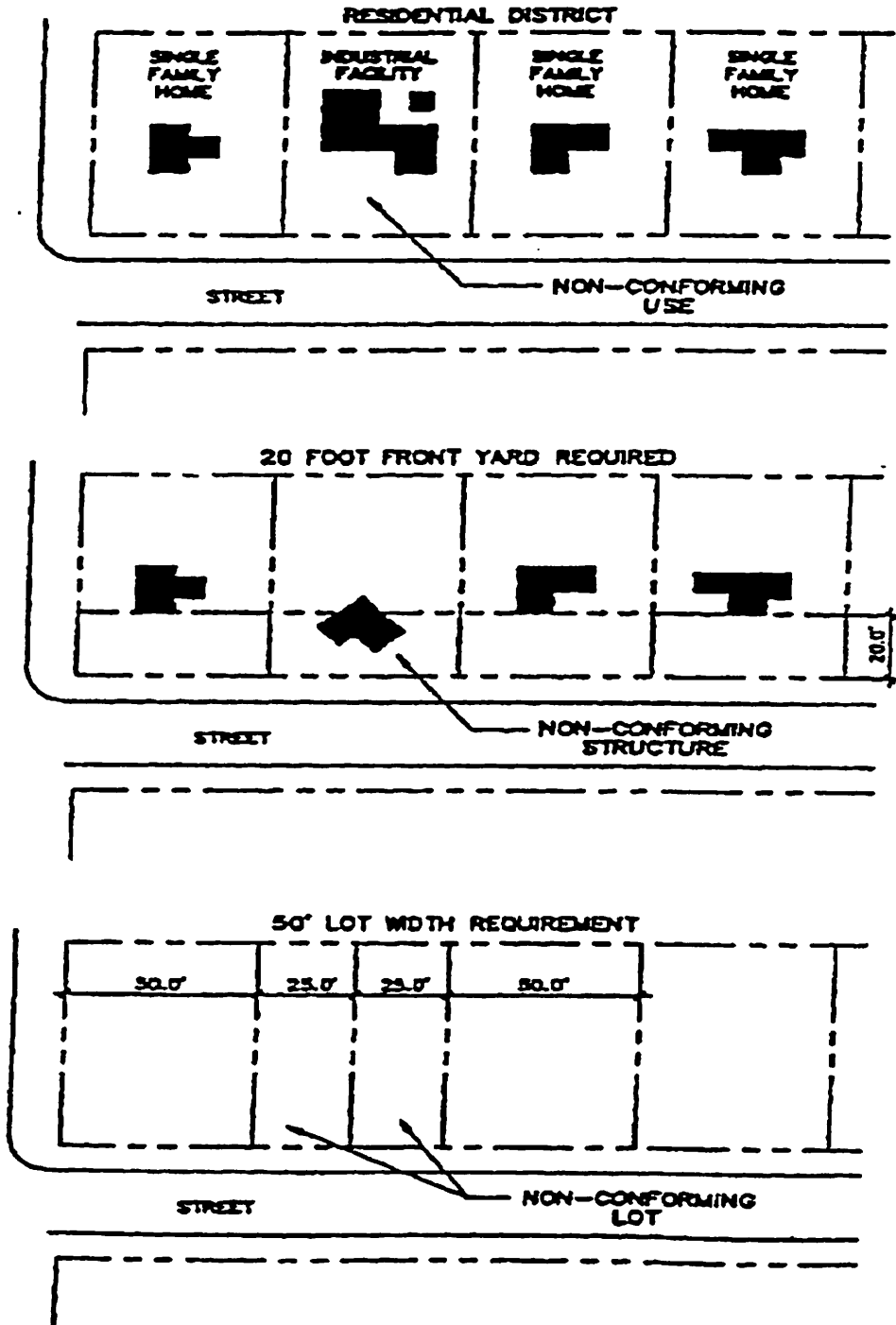

(Ord. A-38, §§ 4.01 and 4.02, passed 10-18-1988)

(H) Floor area measurement for off-street parking and loading requirements. See measurement unit definitions in § 152.086.

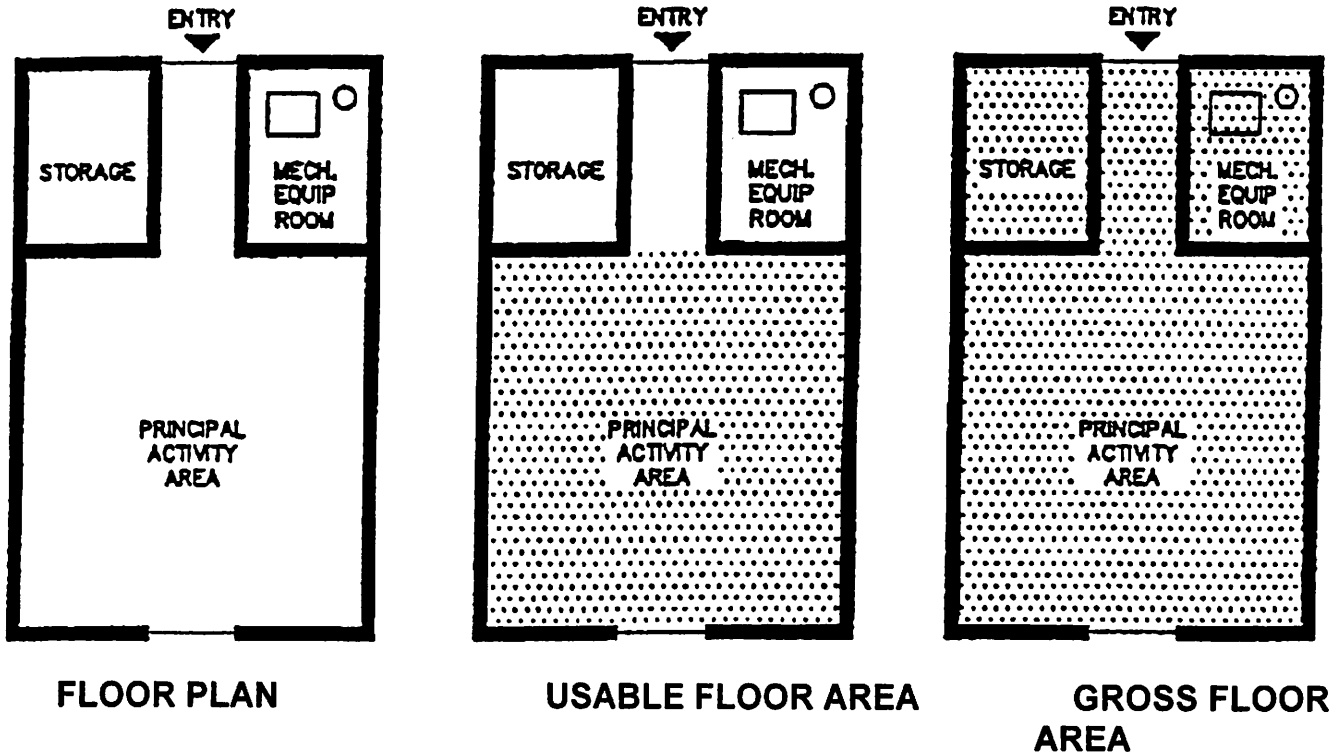

(Ord. A-38, § 13.02, passed 10-18-1988)

(1) *Sign types.* See sign regulations in §§ 152.105 et seq.

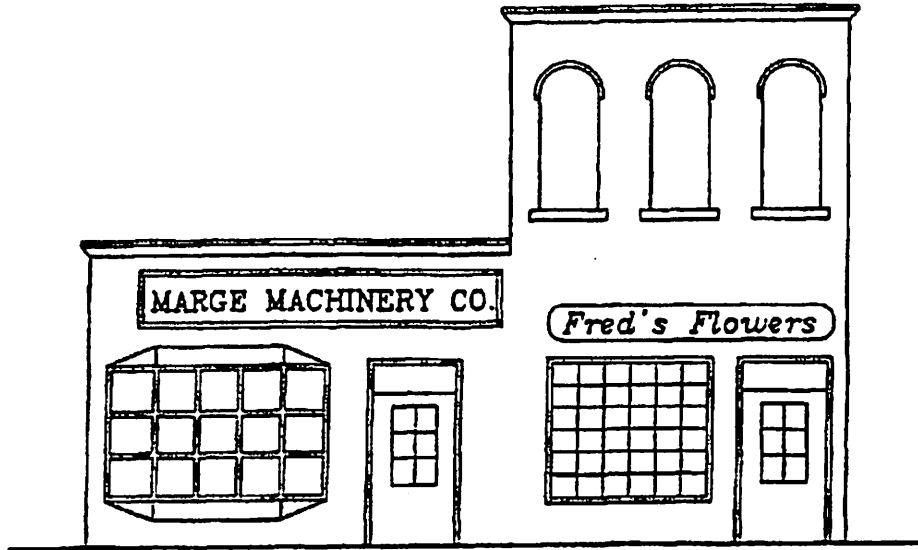

WALL SIGNS

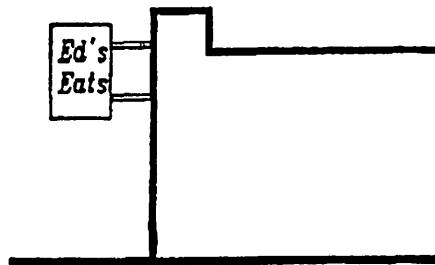

PROJECTING SIGN



FREESTANDING SIGNS

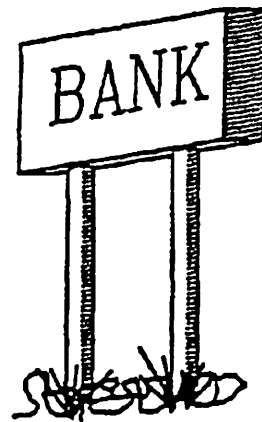

GROUND MOUNTED SIGN

(Ord. A-38, Art. 14, passed 10-18-1988)

APPENDIX D: OFFICIAL ZONING MAP

Editor's note: See the colored map located at the end of this chapter.

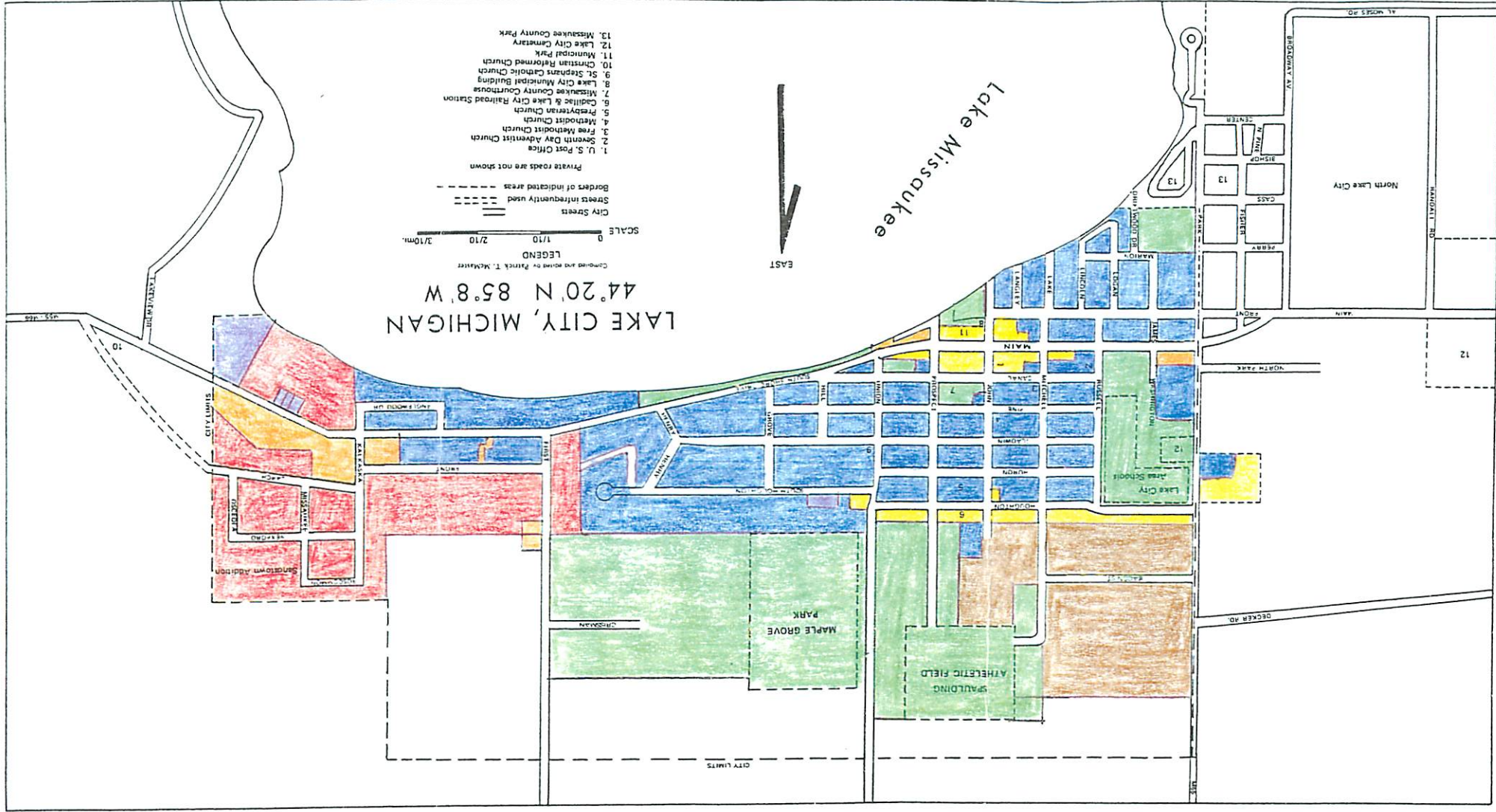

LAKE CITY, MICHIGAN
 44° 20' N 85° 8' W

- LEGEND
 Compiled and drawn by Patrick T. McKeever
- SCALE
 0 1/10 2/10 3/10mi.
- City Streets
 Streets infrequently used
 Borders of indicated areas
 Private roads are not shown
1. U. S. Post Office
 2. Seventh Day Adventist Church
 3. Free Methodist Church
 4. Methodist Church
 5. Presbyterian Church
 6. Cadillac & Lake City Railroad Station
 7. Missaukee County Courthouse
 8. Lake City Municipal Building
 9. St. Stephens Catholic Church
 10. Christian Reformed Church
 11. Municipal Park
 12. Lake City Cemetery
 13. Missaukee County Park

- | | | |
|-------------|-------------|-------------|
| AG-1 | Public Land | AG-1 |
| I-1 | Public Land | I-1 |
| INDR | Public Land | INDR |
| C-2 | Public Land | C-2 |
| R-1 | Public Land | R-1 |
| R-2 | Public Land | R-2 |
| R-2 | Public Land | R-2 |
| C-1 | Public Land | C-1 |
| Core Comm'l | Public Land | Core Comm'l |